

# HONDA OUTBOARD MOTOR BF20A • BF25A

# SHOP MANUAL NEWS

Power Equipment

News No. P/P-032	Issue Date August '94
---------------------	--------------------------

## SOME PARTS OF CHANGES

Applicable information	Publication No.
BF20A • BF25A	66ZV700

## CHANGE LOCATIONS

The part numbers of the pin driver, 4mm and the special tool illustrations have been corrected as follows.

- Pin driver , 4mm

### BEFORE MODIFICATION

07944-9350200



### AFTER MODIFICATION

07744-0010300  
or 07944-SA00000

- Special tool illustrations

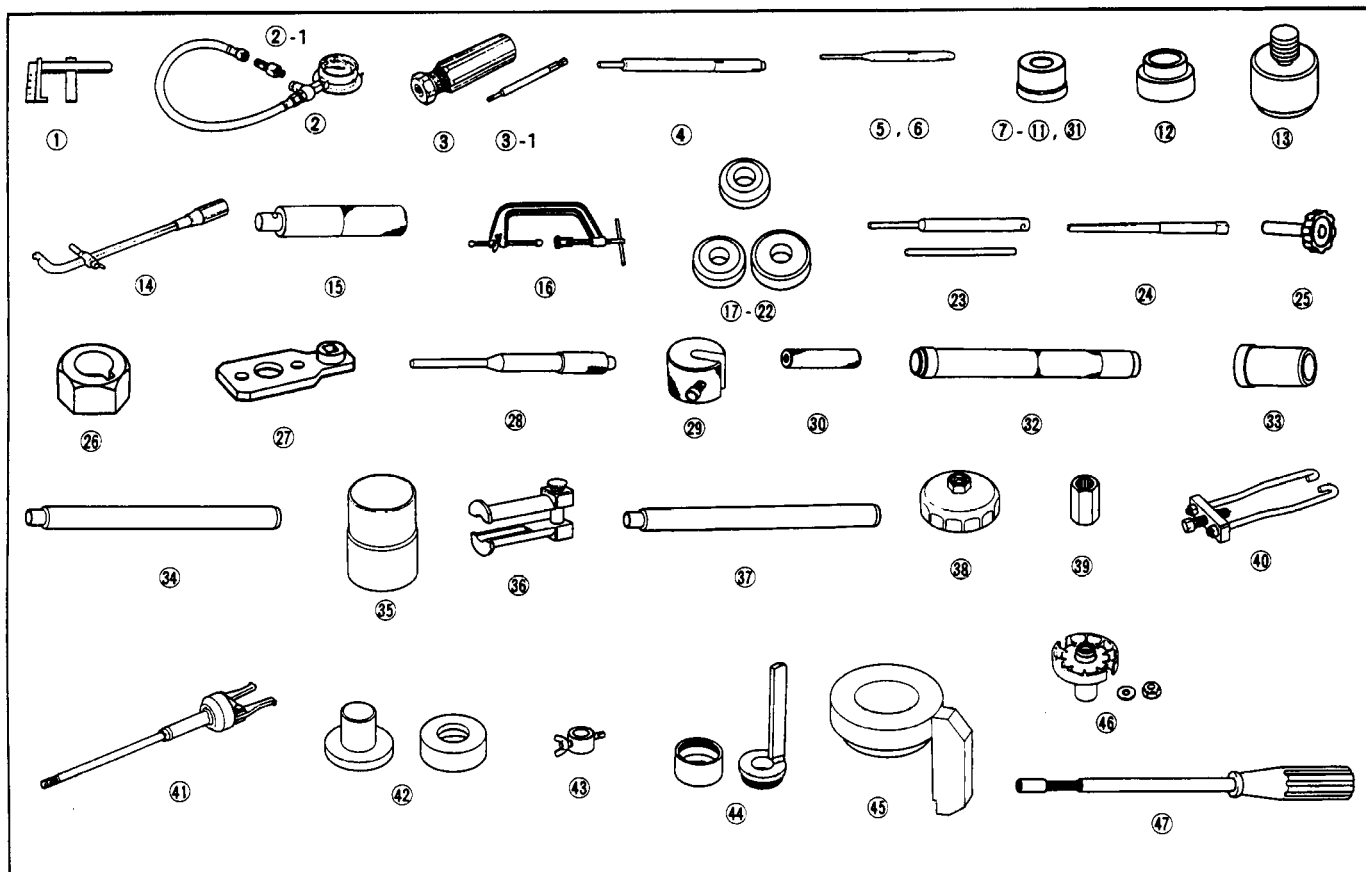

HONDA MOTOR CO., LTD.  
SERVICE PUBLICATIONS