

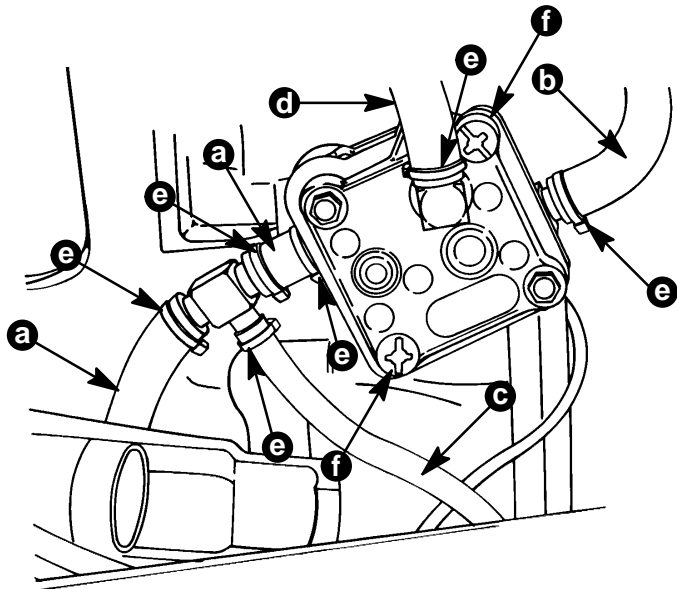

Fuel Pump Removal

1. Remove oil tank from outboard. Refer to Section 8A "Oil Injection System."
2. Remove fuel "inlet" hose, (a) "outlet" hose, (b) and pulse hose (d).
3. Remove two bolts (f) securing fuel pump to power-head.



51267

- a - Inlet Fuel Hose
- b - Outlet Fuel Hose
- c - Oil Injection hose - From Oil Tank
- d - Pulse Hose - From Crankcase
- e - Sta-Strap (6)
- f - Bolts (2)

4. Remove gasket from backside and replace gasket as necessary -- check gasket in port area.

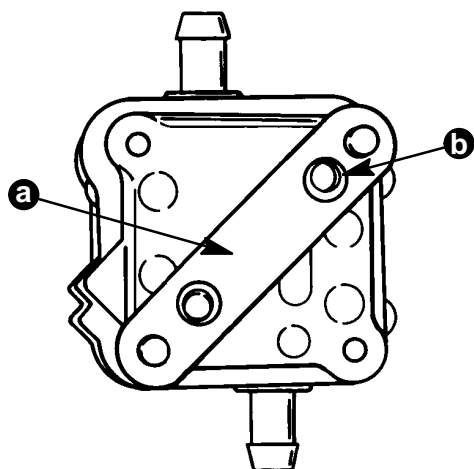

51267

- a - Gasket
- b - Port Area

Fuel Pump Disassembly

1. Remove bolts (a) and chamber plate (b).

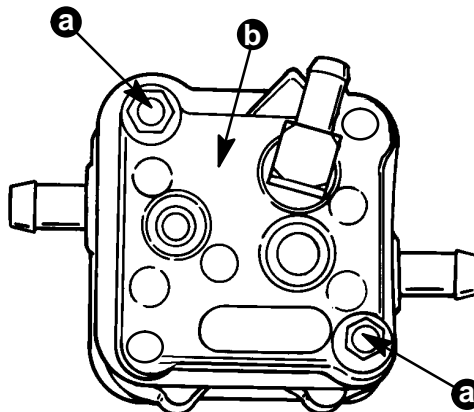

51267

2. Disassemble fuel pump as shown in "Fuel Pump Exploded View."

Cleaning and Inspection

1. Clean fuel pump housing, chamber plate and pump base, then dry with compressed air.
2. Look at spring for signs of bad coils or other damage.
3. Check pump body, chamber plate and pump base, for cracks or rough gasket surfaces.
4. Check hoses for looseness or signs of leakage.
5. Look at check valve discs for cracks, tears, or other damage.
6. Repair of fuel pump is limited to the replacement of those bad parts found during inspection.